

1

2

3

4

5

SEE DETAIL A

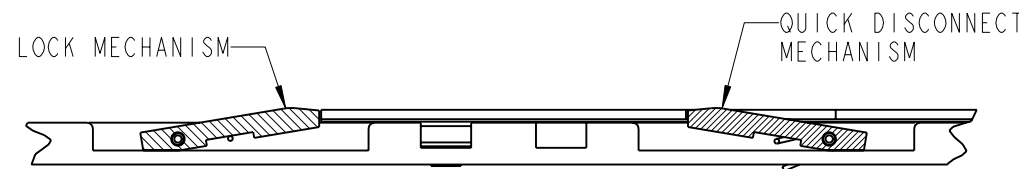
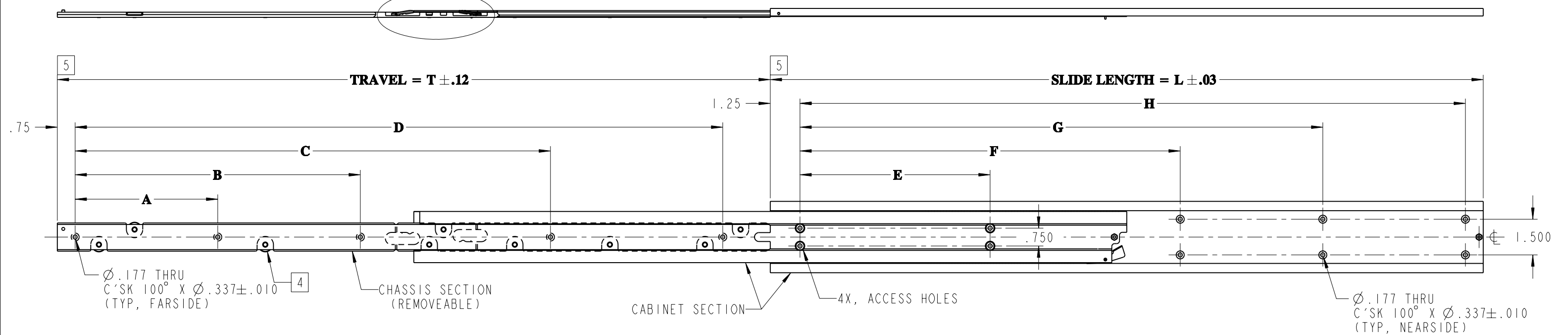

DETAIL A

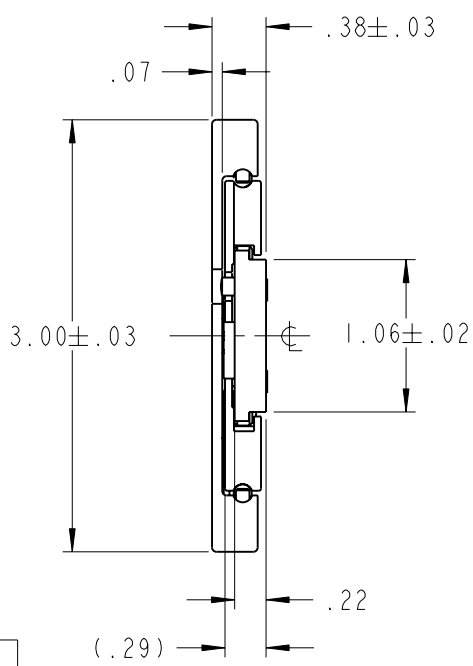

END VIEW

8. LEFT HAND SLIDE SHOWN. RIGHT HAND SLIDE OPPOSITE.
7. USE #8 100° FLAT HEAD MACHINE SCREWS FOR MOUNTING THRU THE SLIDE MEMBERS.
6. CABINET SECTION OR CHASSIS SECTION MAY BE PURCHASED SEPARATELY AND ARE INTERCHANGEABLE.
- 5 FOR REFERENCE PURPOSE ONLY, THESE SURFACES TO ALIGN WHEN SLIDE IS IN CLOSED POSITION.
- 4 AMOUNT AND LOCATION OF BALL BEARING ROLLERS DETERMINED BY JONATHAN ENGINEERED SOLUTIONS.
3. SLIDE LOCKS IN FULL OPEN POSITION AND IS PROVIDED WITH QUICK DISCONNECT OF CHASSIS SECTION.
2. FINISH: SLIDE CHANNELS AND ALUMINUM COMPONENTS ARE ANODIZED PER MIL-A-8625, TYPE II, CLASS I. CRES COMPONENTS ARE PASSIVATED PER SAE-AMS-QQ-P-35.
1. MATERIAL: SLIDE CHANNELS ARE FABRICATED FROM ALUMINUM ALLOY 7075-T6. COMPONENT PARTS ARE 302/303 CRES AND HIGH STRENGTH ALUMINUM. BALL BEARINGS ARE 440 CRES.

PART NO.	SLIDE LENGTH	SLIDE TRAVEL	CHASSIS SECTION				CABINET SECTION				LOAD RATING PER PAIR
			A	B	C	D	E	F	G	H	
138QD-10	10.00	10.00	2.750	-	-	7.625	-	-	5.000	8.000	170 LBS
138QD-12	12.00	12.00	3.750	-	-	9.500	-	-	6.000	10.000	181 LBS
138QD-14	14.00	14.00	4.000	-	9.750	11.250	-	-	7.000	12.000	174 LBS
138QD-16	16.00	16.00	4.500	-	11.000	13.250	4.000	8.000	11.000	14.000	162 LBS
138QD-18	18.00	18.00	5.500	-	12.000	15.250	5.000	10.000	13.000	16.000	154 LBS
138QD-20	20.00	20.00	4.000	7.000	14.000	17.250	5.000	10.000	14.000	18.000	147 LBS
138QD-22	22.00	22.00	4.000	8.000	15.000	19.250	6.000	12.000	16.000	20.000	140 LBS
138QD-24	24.00	24.00	5.000	9.000	16.500	21.250	6.000	12.000	17.000	22.000	134 LBS
138QD-26	26.00	26.00	5.500	9.500	17.500	23.250	7.000	14.000	19.000	24.000	130 LBS
138QD-28	28.00	28.00	5.500	10.000	18.750	25.250	7.000	14.000	20.000	26.000	128 LBS
138QD-30	30.00	30.00	6.000	12.000	20.000	27.250	8.000	16.000	22.000	28.000	116 LBS



Irvine Technology Center
 410 Exchange, Suite 200
 Irvine, CA 92602
 Tel. (714) 665-4400
 Fax: (714) 368-7002
 Website: www.jonathanengr.com
 Engineer - Production - Integration/ Subassembly - Logistics
 United States - Mexico - China - Taiwan

TOLERANCES UNLESS OTHERWISE NOTED				PART NUMBER : 138QD		DESCRIPTION : ALUMINUM SERIES 138QD LOAD RATING : 116-170 LBS.
.XX	.XXX	ANGLES	HOLES	DATE : 05/14/09		
± .01	± .005	± 1°	± .005			
SHEET 1 OF 1				COPYRIGHT © 2009 JONATHAN ENGINEERED SOLUTIONS		

1

2

3

4

5