

- NOTES:
- LEFT SLIDE AS SHOWN, RIGHT SLIDE OPPOSITE.
  - FOR LOCKING DEVICES, SEE SEPARATE SECTION.
  - MOUNTING HOLE TOLERANCE:  $\pm .005$   
[ $\pm .13$ ]

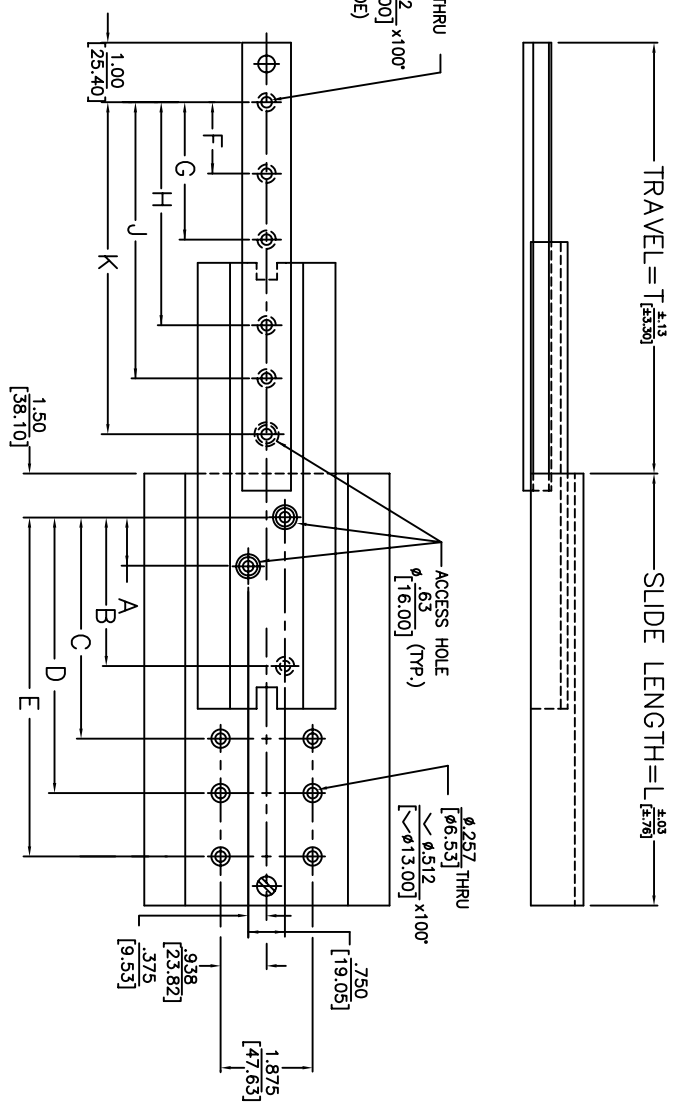
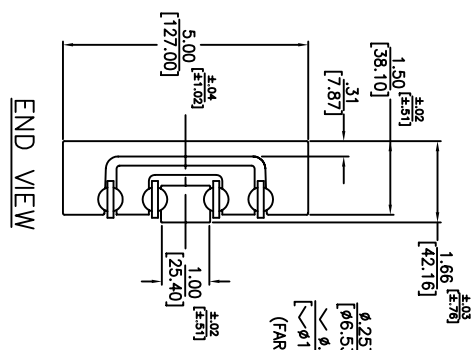
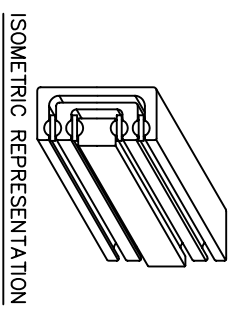

PART NO.	SERIES	DIM. LENGTH	DIM. T	MOUNTING HOLE PATTERN											LOAD RATING	
				A	B	C	D	E	F	G	H	J	K			
182-14	L	14	13	4												980 LBS
182-16	L	16	15	4												980 LBS
182-18	L	18	17	5												845 LBS
182-20	L	20	19	6												760 LBS
182-22	L	22	21	7												700 LBS
182-24	L	24	23	8												670 LBS
182-26	L	26	25	9												640 LBS
182-28	L	28	27	10												615 LBS
182-30	L	30	29	11												600 LBS
182-32	L	32	31	12												590 LBS
182-34	L	34	33	13												580 LBS
182-36	L	36	35	14												565 LBS
		31.4	30.8	17.7												256 KG

**Jonathan Engineering Solutions**

Website: [www.jonathanengr.com](http://www.jonathanengr.com)  
 Engineering • Production • Integration • Subassembly • Logistics  
 United States • Mexico • China • Taiwan

DIMENSIONS SHOWN IN: [MM]	PART NO. 182	DESCRIPTION: ALUMINUM SERIES 182
TOLERANCE UNLESS OTHERWISE NOTED	DATE: 6/04	LOAD RATING: 565-980 LBS. / 256-444 KG.
AS: [TOLERANCE]		
XX ±.010		
X ±.005		
XXX ±.005		
XX ±.13		
ANGLES ±1°		

COPYRIGHT © 2004 JONATHAN ENGINEERED SOLUTIONS