

LOCK MECHANISM

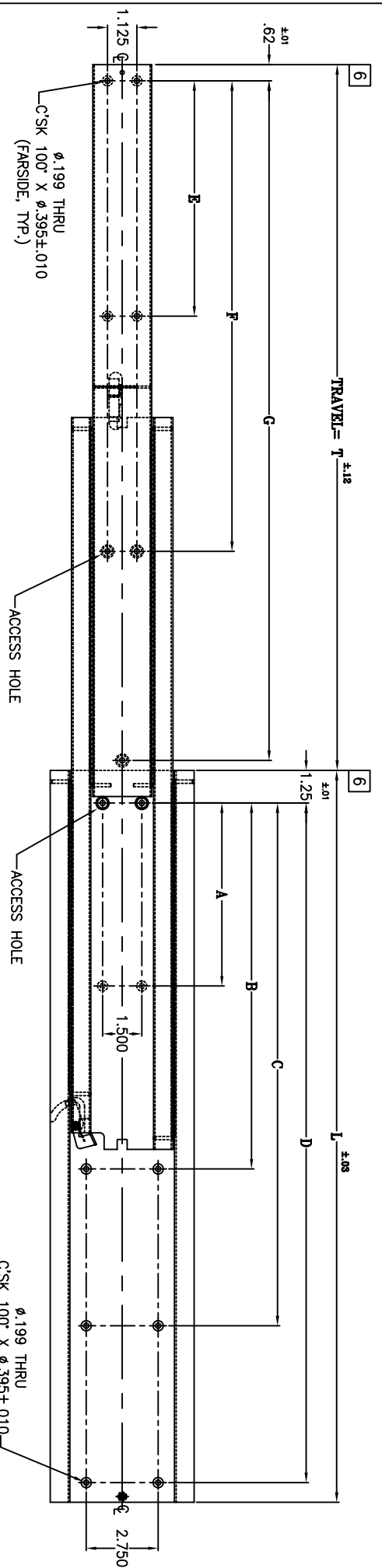

- SLIDE LOCKS IN OPEN POSITION (600L SERIES)
SLIDE STOPS IN OPEN POSITION (600 SERIES)
- LEFT HAND SHOWN, RIGHT HAND OPPOSITE (600L SERIES)
SLIDE IS SYMMETRICAL (600 SERIES)
- FINISH: CHANNELS ARE ANODIZED PER MIL-A-8625 TYPE II, CLASS 1. CRES PARTS PASSIVATED PER SAE-AMS-QQ-P-35.
- MATERIAL: CHANNELS ARE FABRICATED FROM HIGH STRENGTH ALUMINUM ALLOYS WITH TENSILE STRENGTH OF 35,000 PSI MIN. (PER ASTM B221) ALUMINUM ALLOYS. BALL BEARING ARE 440 CRES.

MOUNTING HOLE PATTERN

PART NO.	SLIDE LENGTH	SLIDE TRAVEL	MOUNTING HOLE PATTERN					
SERIES	DIM. L	DIM. T	CABINET SECTION A	B	C	CHASSIS SECTION E	F	G
600L-10	10	9	-	5.000	8.000	-	6.000	8.000
600L-11	11	10	-	5.000	9.000	-	7.000	9.000
600L-12	12	11	-	6.000	10.000	-	7.000	10.000
600L-13	13	12	-	6.000	11.000	-	8.000	11.000
600L-14	14	13	-	7.000	12.000	4.000	8.000	12.000
600L-15	15	14	-	7.000	13.000	4.000	9.000	13.000
600L-16	16	15	4.000	8.000	11.000	14.000	4.000	9.000
600L-17	17	16	5.000	9.000	12.000	15.000	5.000	10.000
600L-18	18	17	5.000	10.000	13.000	16.000	5.000	10.000
600L-19	19	18	5.000	10.000	13.000	17.000	5.000	10.000
600L-20	20	19	5.000	10.000	14.000	18.000	4.000	12.000
600L-21	21	20	6.000	12.000	15.000	19.000	6.000	13.000
600L-22	22	21	6.000	12.000	16.000	20.000	7.000	14.000
600L-23	23	22	6.000	12.000	16.000	21.000	7.000	14.000
600L-24	24	23	6.000	12.000	17.000	22.000	8.000	15.000
600L-25	25	24	7.000	14.000	18.000	23.000	8.000	15.000
600L-26	26	25	7.000	14.000	19.000	24.000	8.000	15.000
600L-27	27	26	7.000	14.000	19.000	25.000	8.000	17.000
600L-28	28	27	7.000	14.000	20.000	26.000	9.000	18.000

- ORDERING INFORMATION:
600-XX (SLIDE WITHOUT LOCK, XX = LENGTH OF SLIDE)
600L-XXL (SLIDE WITH LOCK, LEFT HAND)
600L-XXR (SLIDE WITH LOCK, RIGHT HAND)
- EX: 600-12 (SLIDE WITHOUT LOCK, 12" LONG)
600L-12L (SLIDE WITH LOCK, 12" LONG, LEFT HAND)
600L-12R (SLIDE WITH LOCK, 12" LONG, RIGHT HAND)
- THESE SURFACES ALIGN WHEN SLIDE IS IN THE CLOSED POSITION.
- SLIDE IS SOLID PACKED WITH BALLS.

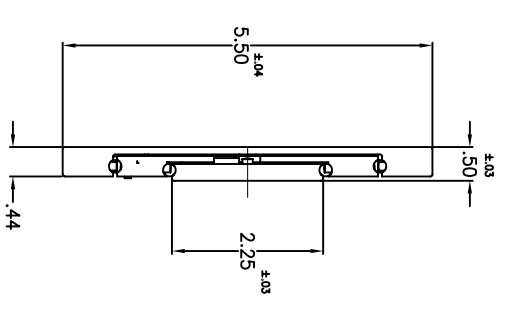

JONATHAN

Inyne Technology Center
410 Exchange Suite 200
Inyne CA 92502
Tel: (714) 665-4400

PART NO. 600L & 600
DATE: 02.14.08

DESCRIPTION: ALUMINUM SERIES 600L SERIES 600