

QUICK DISCONNECT MECHANISM
DEPRESS LEVER TO REMOVE CHASSIS MEMBER (T-SECTION)

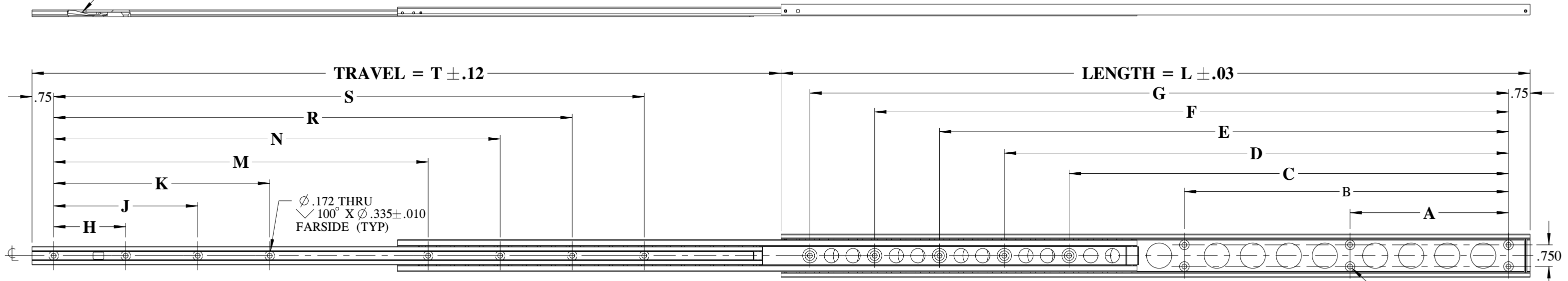

- 6. HOLES OTHER THAN THOSE SHOWN MAY BE IN THE SLIDE AT JONATHAN'S OPTION.
- 5. USE #8 X 100° FLAT HEAD MACHINE SCREWS FOR MOUNTING THROUGH THE SLIDE MEMBERS.
- 4. SLIDE FEATURES QUICK DISCONNECT OF CHASSIS SECTION.
- 3. SLIDE IS SYMMETRICAL AND MAY BE USED AS LEFT OR RIGHT HAND SLIDE.
- 2. FINISH: CHANNELS ARE ANODIZED PER MIL-A-8625 TYPE II, CLASS 2, COLOR BLACK OR TYPE II, CLASS 1 (CLEAR). CRES PARTS ARE PASSIVATED PER SAE-AMS-2700.
- 1. MATERIALS: SLIDE CHANNELS ARE FABRICATED FROM HIGH STRENGTH ALUMINUM ALLOYS WITH A TENSILE STRENGTH OF 35,000 PSI MIN. (PER ASTM B221) COMPONENT PARTS ARE FABRICATED FROM HIGH STRENGTH ALUMINUM ALLOYS AND CORROSION RESISTANT STEEL AND NYLON. BALLS ARE 440 CRES OR ACETAL.

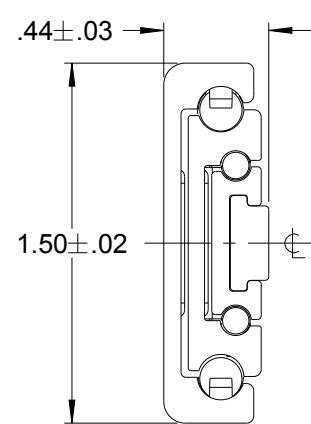

END VIEW

ORDERING PART NUMBER DESIGNATIONS

E144TPB-XX

- SLIDE LENGTH
- BLACK FINISH (BLANK IF CLEAR)
- POLYMER BALL BEARINGS (BLANK IF STAINLESS STEEL)
- SLIDE MODEL 144 T-SECTION
- EXECUTIVE SERIES

SERIES LENGTH	SLIDE LENGTH	SLIDE TRAVEL	MOUNTING HOLE PATTERN														LOAD RATING	SLIDE WEIGHT
			CABINET SECTION							CHASSIS SECTION								
PART NUMBER	L	T	A	B	C	D	E	F	G	H	J	K	M	N	R	S	LBS/PAIR	LBS
E144T-6	6.00	6.00	-	-	2.000	-	-	-	4.250	-	-	-	-	-	-	3.500	60	.21
E144T-7	7.00	7.00	-	-	3.000	-	-	-	5.250	2.500	-	-	-	-	-	4.500	60	.25
E144T-8	8.00	8.00	3.000	-	4.000	-	-	-	6.250	2.750	-	-	-	-	-	5.500	70	.28
E144T-9	9.00	9.00	3.000	-	5.000	-	-	-	7.250	3.250	-	-	-	-	-	6.500	70	.32
E144T-10	10.00	10.00	4.000	-	6.000	-	-	-	8.250	3.250	-	-	-	-	-	6.500	90	.37
E144T-11	11.00	11.00	4.000	-	7.000	-	-	-	9.250	2.500	-	-	6.000	-	-	8.500	90	.40
E144T-12	12.00	12.00	4.000	-	8.000	-	-	-	10.250	2.500	-	-	6.000	-	-	8.500	100	.43
E144T-13	13.00	13.00	5.500	-	9.000	-	-	-	11.250	2.500	-	-	6.000	-	-	8.500	100	.47
E144T-14	14.00	14.00	5.500	-	10.000	-	-	-	12.250	2.500	-	5.000	9.000	-	-	11.500	105	.51
E144T-15	15.00	15.00	5.500	-	11.000	-	-	-	13.250	2.500	-	5.000	9.000	-	-	11.500	105	.54
E144T-16	16.00	16.00	5.500	-	7.500	9.750	12.000	-	14.250	2.500	-	5.000	9.000	-	-	11.500	110	.59
E144T-17	17.00	17.00	5.500	-	8.500	10.750	13.000	-	15.250	2.500	-	5.000	9.000	-	-	11.500	110	.62
E144T-18	18.00	18.00	5.500	-	9.500	11.750	14.000	-	16.250	2.500	-	5.000	8.500	11.000	-	13.500	105	.67
E144T-19	19.00	19.00	5.500	-	10.500	12.750	15.000	-	17.250	2.500	-	5.000	8.500	11.000	-	13.500	100	.70
E144T-20	20.00	20.00	5.500	-	11.500	13.750	16.000	-	18.250	2.500	-	5.000	8.500	11.000	-	13.500	100	.74
E144T-21	21.00	21.00	5.500	-	12.500	14.750	17.000	-	19.250	2.500	5.000	7.500	11.500	14.000	-	16.500	100	.77
E144T-22	22.00	22.00	5.500	-	13.500	15.750	18.000	-	20.250	2.500	5.000	7.500	11.500	14.000	-	16.500	95	.81
E144T-23	23.00	23.00	5.500	-	12.250	14.500	16.750	19.000	21.250	2.500	5.000	7.500	11.000	13.500	16.000	18.500	95	.85
E144T-24	24.00	24.00	5.500	-	13.250	15.500	17.750	20.000	22.250	2.500	5.000	7.500	11.000	13.500	16.000	18.500	90	.89
E144T-25	25.00	25.00	5.500	11.250	14.250	16.500	18.750	21.000	23.250	2.500	5.000	7.500	13.000	15.500	18.000	20.500	80	.92
E144T-26	26.00	26.00	5.500	11.250	15.250	17.500	19.750	22.000	24.250	2.500	5.000	7.500	13.000	15.500	18.000	20.500	70	.96
E144T-27	27.00	27.00	5.500	11.250	16.250	18.500	20.750	23.000	25.250	2.500	5.000	7.500	15.000	17.500	18.000	22.500	60	1.11
E144T-28	28.00	28.00	5.500	11.250	17.250	19.500	21.750	24.000	26.250	2.500	5.000	7.500	15.000	17.500	20.000	22.500	60	1.22
E144T-30	30.00	30.00	5.500	11.250	19.250	21.500	23.750	26.000	28.250	2.500	5.000	7.500	17.000	19.500	22.000	24.500	50	1.30

LATERAL SUPPORT - MOUNTING RECOMMENDATION

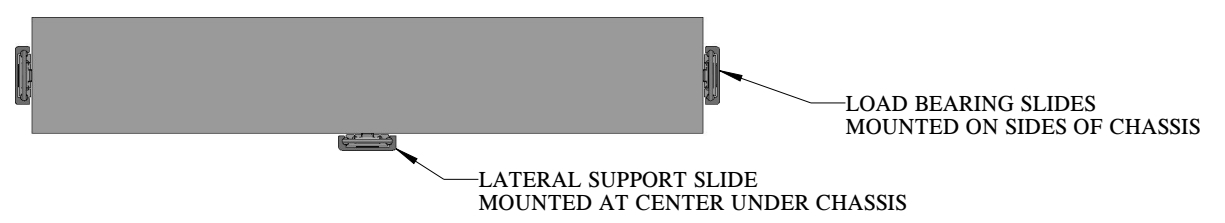

Irvine Technology Center
250 Commerce, Suite 100
Irvine, CA 92602
Tel. (714) 665-4400
Fax: (714) 368-7002
Website: www.jonathanengr.com
Engineer - Production - Integration/ Subassembly - Logistics
United States - Mexico - China - Taiwan

TOLERANCES UNLESS OTHERWISE NOTED				PART NUMBER : E144T		DESCRIPTION : ALUMINUM SERIES E144T LOAD RATING: 50-110 LBS	
.XX	.XXX	ANGLES	HOLES	DATE : 10/16/20			
± .01	± .005	± 1°	± .005	SHEET 1 OF 1		COPYRIGHT © 2012 JONATHAN ENGINEERED SOLUTIONS	